



BATbox 2S

USER MANUAL

SAFETY INSTRUCTIONS

This manual belongs to the installation box BATbox 2S that is especially made for the installation of the bat-monitoring system BATmode at wind turbines. Please read these instructions completely and carefully before mounting the BATbox 2S or installing the BATmode system. The safety instructions contained within must be observed.

Ensure a secure mounting of the BATbox 2S.

Dropping parts can harm persons or equipment.

Ensure that nobody can stumble on the BATbox 2S or installed power cable.

Stumbling can harm persons and damage system parts.

Only use accessories supplied or authorized by bat bioacoustictechnology.

The use of unauthorized accessories may damage the device.

Please contact our support if the BATbox 2S shows any damage or does not work properly.

Do not open system parts and try to repair damage by yourself or through unauthorized personnel.

This will cause the loss of warranty.

When working on/in electrical plants, always follow the five safety rules in accordance with EN50110:

1. Disconnect mains.
2. Secure against being switched on again.
3. Determine voltage free status.
4. Earth and short-circuit.
5. Provide protection by covers or barriers for any neighboring live parts.



Connect the BATbox 2S never to a multiple socket.

If the integrated power socket shows any external damages caused by transport or improper handling, it have to be taken out of service immediately.

Keep the integrated power socket away from rain and moisture. Ingress of water may cause an electrical shock.

To pull the power plug from the socket, pull the power plug directly, never pull the power cable.

Do not expose the equipment to extreme temperatures, solar radiation, high humidity or moisture.

Installation of the BATmode System

Required Tools

None

Step 1: BATmode

Hook the DIN rail adapter of the BATmode in the center of the DIN rail on which the power socket is not located. The on/off switch of the BATmode should face away from the cabinet door (see page 6). Now press the BATmode down, the DIN rail adapters will audibly click into place.



Step 2: Power Supply

Remove the Velcro power supply holder from the BATbox 2S and attach the power supply of the BATmode using the Velcro strip. Then reattach the power supply holder to the DIN rail next to the BATmode. Connect the BATmode to the power supply unit and plug it into the power socket of the BATbox 2S.



Step 3: UltraSoundGate(s)

Attach the UltraSoundGate 116Hnbm in the black bracket next to the BATmode. Connect it to one of the two UltraSoundGate ports on the front of the BATmode. If two or more microphone channels are used, additional UltraSoundGates and a required USB hub can be placed on the second DIN rail.

Step 4: Strain Reliefs

Feed the cables for microphones through the left-hand cable opening in the BATbox 2S and all other cables through the right-hand cable opening. For strain relief, snap the strain reliefs onto the DIN rail directly in front of the cable openings and secure the cables with cable ties.

Step 5: Sealing Inserts

The cable openings can be sealed with optionally available sealing inserts. To install the sealing inserts, unscrew the inner part of the sealing frame and press the bars and sealing inserts into the outer sealing frame. Then reinstall the inner part of the sealing frame.

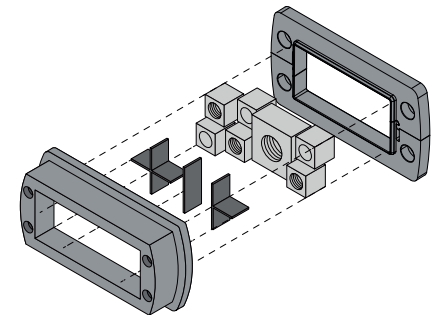

Mounting the BATbox 2S

Required tools

- 4 screws (maximum \varnothing 8mm)
- Screwdriver
- Possibly drill for predrilling mounting holes

The BATbox 2S has a mounting hole at every corner. Possibly, predrilling and the use of dowels may be necessary. For the exact positions of the holes, please see the adjacent drawing. Ensure an adequate earthing of the BATbox 2S and all components, possibly with an optionally available earthing cable).

To attach the BATbox 2S to a steel wall in the wind turbine, you can also use the optionally available magnetic feet. These have to be attached to the mounting holes of the BATbox 2S using the supplied screws.

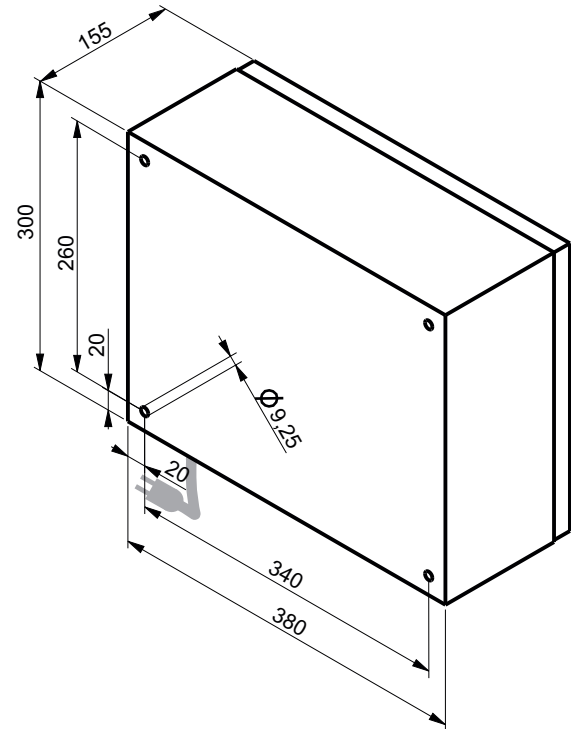



bio
acoustic
technology

bat bioacoustictechnology GmbH
Brunngasse 1
D-90610 Winkelhaid
www.bioacoustictechnology.de
info@bioacoustictechnology.de
+49 (0) 9187 / 956519

Version: 01/24

Product illustrations similar. Misprints, errors, innovations
and changes reserved.